

Metric flat cable screwing

Description

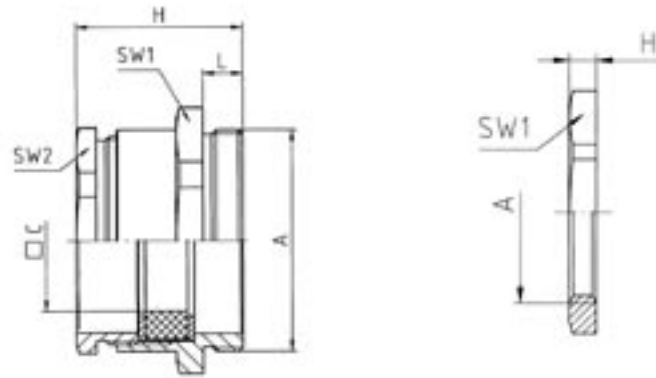

Application

Screws for flat cables can be installed e.g. in the crane industry, mechanical engineering, plant construction and drag chain plants.

Flat cable screwing

Design

Pressure screw: BrassCuZn39Pb3, nickel-plated
 Washer: Steel, zinc-plated
 Sealing ring: SBR
 Gland body: Brass CuZn39Pb3, nickel-plated
 Connecting thread: metric in accordance with EN 60423

Properties for chamfered flat cables

Temperature range: -30°C / +80°C
 Protection grade: maximum IP55
 smaller cables could be used at a lower protection grade
 Option: connecting thread long available upon request

Counternut

Design

Counternut: Brass CuZn39Pb3, nickel-plated
 Internal thread: metric in accordance with EN 60423

Properties

for secure mounting regarding to cable screwing and accessories

Temperature range: up to +200°C

Metric flat cable screwing M 25 x 1,5 - M 63 x 1,5

Discount: _____

Type	Dimensions (mm)			SW1	SW2	H	Part no.	Batch size	Euro/ 100 units
	C	L							
M 25 x 1,5	5x15	7		27	22	27	30.616M25.1	50	239,00
M 25 x 1,5	6x18	7		30	28	29	30.621M25.1	50	251,00
M 25 x 1,5	7,5x19	7		30	28	29	30.621M25.2	50	251,00
M 25 x 1,5	8,5x20	7		30	28	29	30.621M25.3	50	251,00
M 32 x 1,5	6x24	8		40	37	32	30.629M32.1	50	388,00
M 32 x 1,5	8x22	8		40	37	32	30.629M32.4	25	388,00
M 32 x 1,5	9x26	8		40	37	32	30.629M32.5	25	388,00
M 40 x 1,5	6x24	8		43	37	32	30.629M40.1	25	354,00
M 40 x 1,5	6x28	8		43	37	32	30.629M40.2	25	354,00
M 40 x 1,5	7x30	8		43	37	32	30.629M40.3	25	354,00
M 40 x 1,5	8x22	8		43	37	32	30.629M40.4	25	354,00
M 40 x 1,5	9x26	8		43	37	32	30.629M40.5	25	354,00
M 40 x 1,5	10,5x30	8		43	37	32	30.629M40.6	25	354,00
M 50 x 1,5	6x32	9		55	47	37,5	30.636M50.1	10	768,00
M 50 x 1,5	6x35	9		55	47	37,5	30.636M50.2	10	768,00
M 50 x 1,5	7x38	9		55	47	37,5	30.636M50.3	10	768,00
M 50 x 1,5	8x34	9		55	47	37,5	30.636M50.4	10	768,00
M 50 x 1,5	10x32	9		55	47	37,5	30.636M50.5	10	768,00
M 50 x 1,5	12,5x37	9		55	47	37,5	30.636M50.6	10	768,00
M 50 x 1,5	13x34	9		55	47	37,5	30.636M50.7	10	768,00
M 50 x 1,5	6x40	9		57	54	41,5	30.642M50.1	5	844,00
M 50 x 1,5	7,5x40	9		57	54	41,5	30.642M50.2	5	844,00
M 50 x 1,5	11,5x39	9		57	54	41,5	30.642M50.3	5	844,00
M 50 x 1,5	13,5x41	9		57	54	41,5	30.642M50.4	5	844,00
M 63 x 1,5	7x49	10		65	60	44,5	30.648M63.1	5	1.396,00
M 63 x 1,5	10x44	10		65	60	44,5	30.648M63.2	5	1.396,00
M 63 x 1,5	14x44	10		65	60	44,5	30.648M63.3	5	1.396,00
M 63 x 1,5	15,5x45	10		65	60	44,5	30.648M63.4	5	1.396,00

Metric counternut

Type	Dimensions (mm)		Part no.	Batch size	Euro/ 100 units
	SW1	H			
M 12 x 1,5	15	2,8	50.212M	100	17,00
M 16 x 1,5	19	2,8	50.216M	100	18,00
M 20 x 1,5	24	3	50.220M	100	20,00
M 25 x 1,5	30	3,5	50.225M	100	30,00
M 32 x 1,5	36	4	50.232M	100	40,00
M 40 x 1,5	46	5	50.240M	50	67,00
M 50 x 1,5	60	5	50.250M	50	196,00
M 63 x 1,5	70	6	50.263M	50	252,00

ATTENTION !!! All prices plus brass markup !!!